

Remote Control Module Instruction

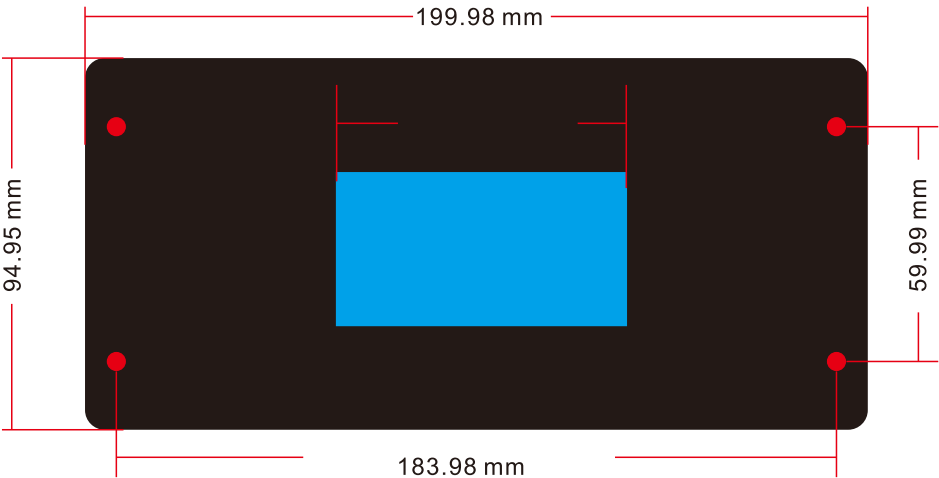

1. Overall Dimensions

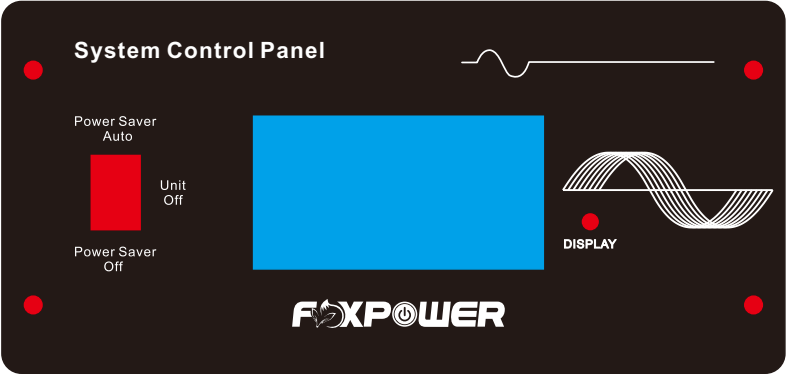

2. Front Impression Drawing

3. Function Description Drawing

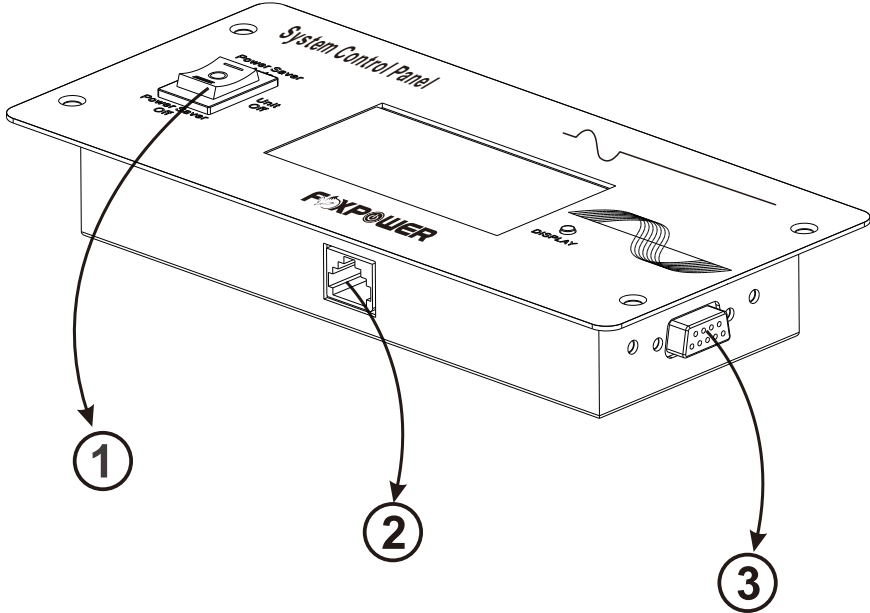

- ① Power Switch ON&OFF
- ② RJ45 Port (Remote Control)
- ③ RS232 Port (Optional)

4.Connection Diagram

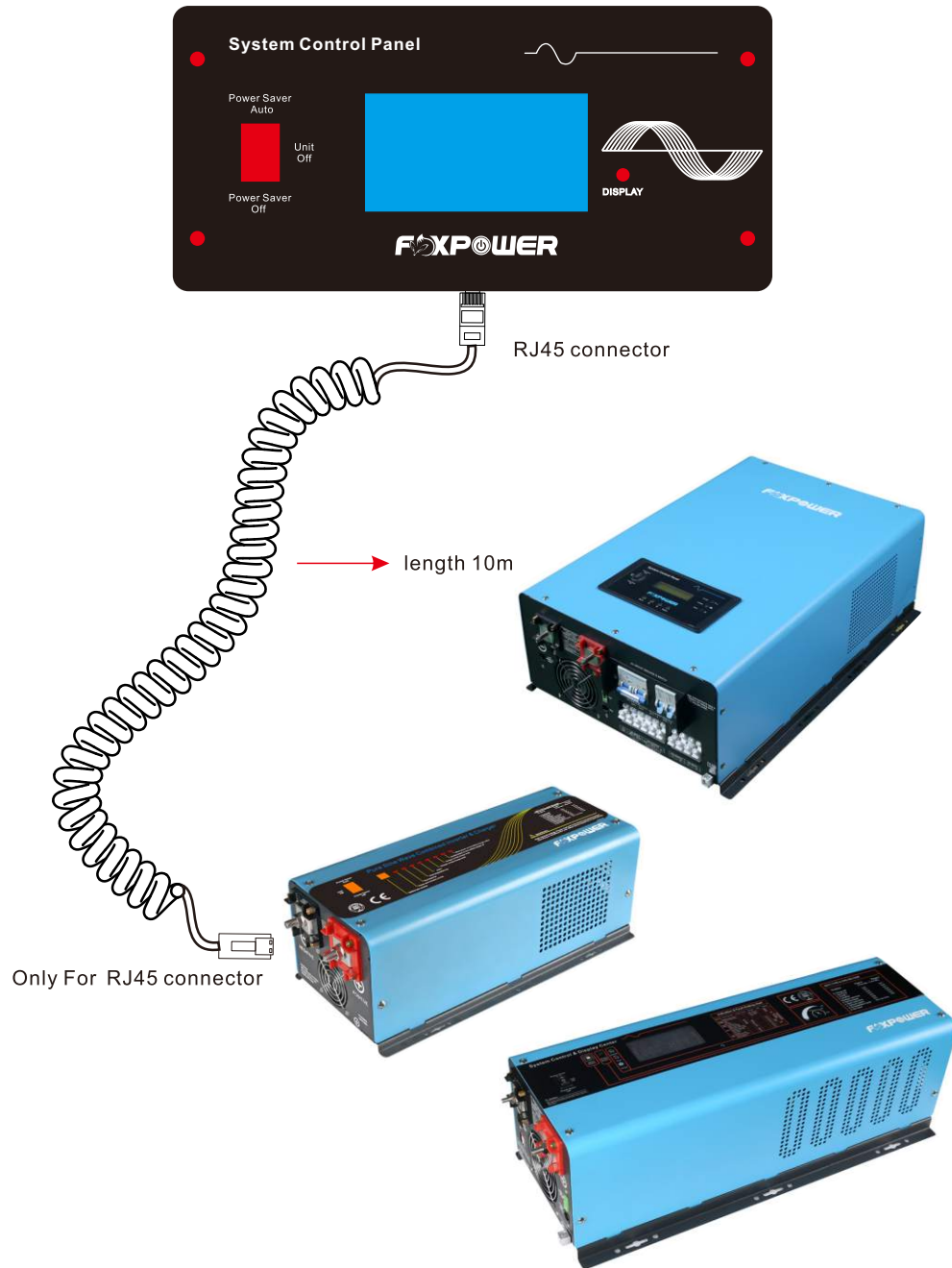

5.LCD Display

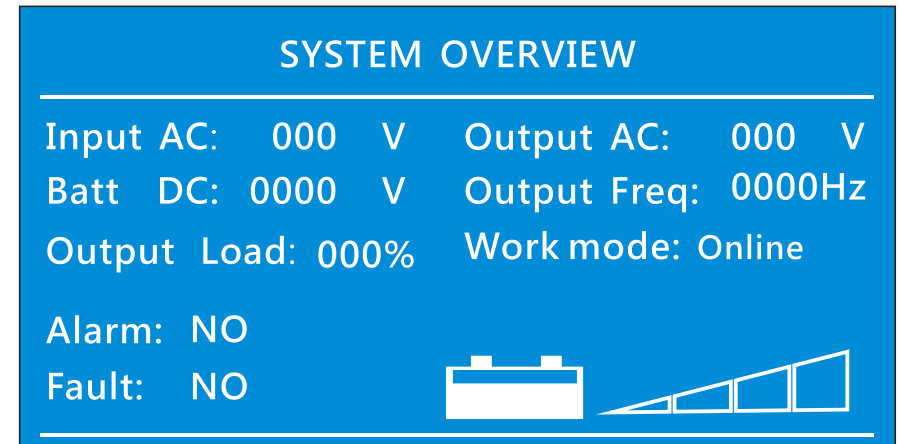

Input Ac: Real AC Input Line Voltage

Batt Dc: Real Battery Voltage Or Charging Voltage

Output Load: Real AC Load Percentage

Alarm: Yes Or No (Ref Manual)

Fault: Yes Or No (Ref Manual)

Output Ac: Real AC Output Voltage

Output Freq: 50Hz Or 60Hz

Work Mode: Online Or Inverter

